

ATTACHMENT 2

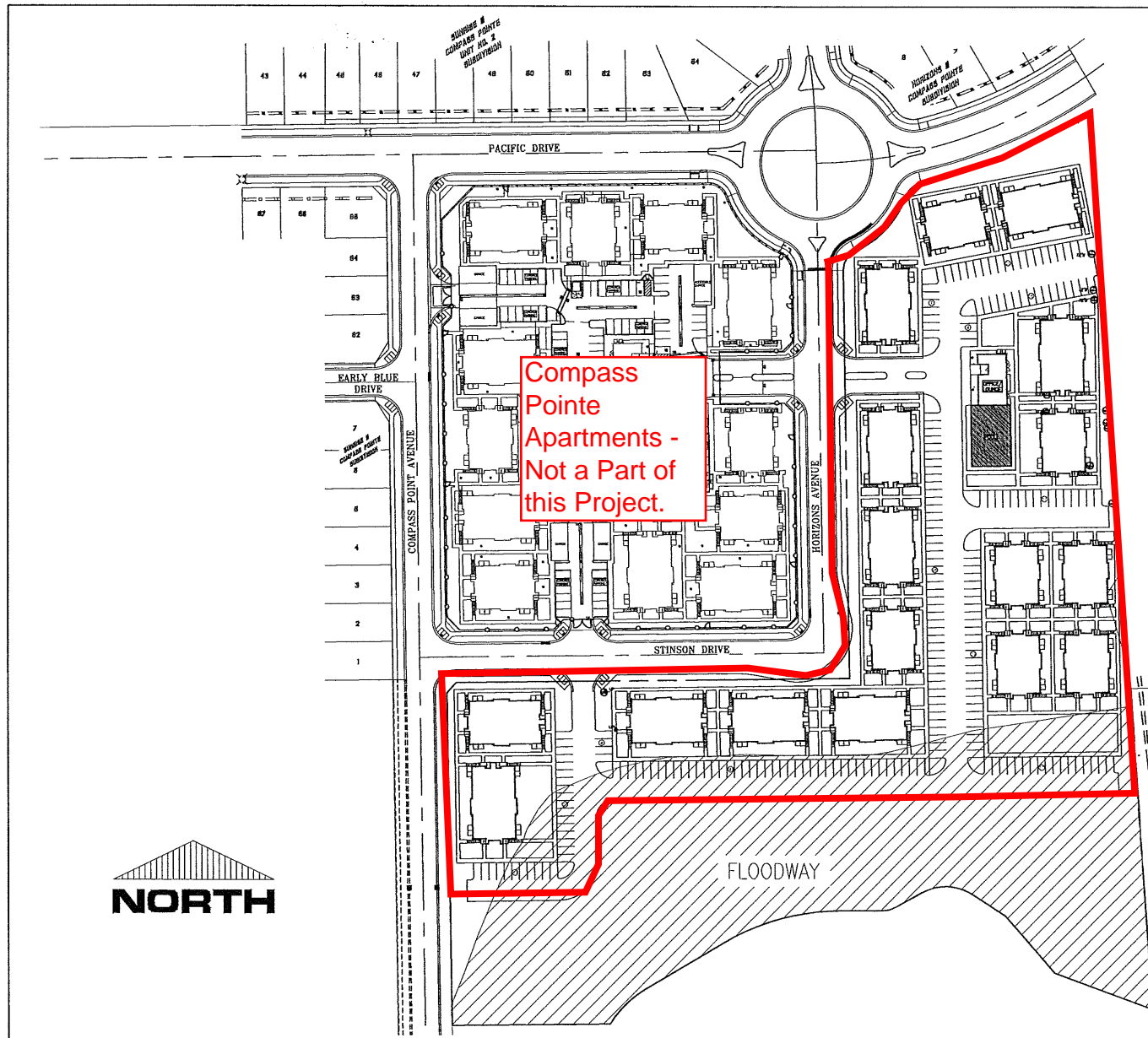

These drawings are the intellectual property of Golden Valley Engineering & Surveying, Inc. All drawings and all other information on these drawings are the property of Golden Valley Engineering & Surveying, Inc. and are to be used only for the project and site indicated on these drawings. No part of these drawings may be reproduced or transmitted in any form or by any means, electronic, mechanical, photocopying, recording, or by any information storage and retrieval system, without the prior written permission of Golden Valley Engineering & Surveying, Inc.

Copyright © 2013 Golden Valley Engineering & Surveying, Inc.

PREPARED BY:

GOLDEN VALLEY
ENGINEERING & SURVEYING

405 West 10th Street 55340
P.O. Box 249
Minnetonka, CA 55341
Tel: (763) 722-3300
Fax: (763) 722-3324

No. _____ Street _____
City _____ State _____ Zip _____

I, the undersigned hereby certify that I am duly qualified to verify the accuracy of all drawings and all other information on these drawings and that I am duly qualified to verify the accuracy of all drawings and all other information on these drawings and that I am duly qualified to verify the accuracy of all drawings and all other information on these drawings.

SITE PLAN
APARTMENT COMPLEX
APN: 206-070-006

SHEET CONTENTS

SITEPLAN

PREPARED FOR
STEINER DEVELOPMENT
554 E. BELLEVUE ROAD, SUITE B
ATWATER, CA 95301
209-070-006

PROJECT DATA

Date: AUGUST 2014

Checked By: JX

Drawn By: KLF

Job No.: 14096

SHEET NUMBER

C1.0