

ALL NOTES, CONDITIONS AND DIMENSIONS SHALL BE READ IN CONJUNCTION WITH THE GENERAL NOTES AND SPECIFICATIONS TO THE PLANS. THE CONTRACTOR SHALL BE RESPONSIBLE FOR OBTAINING ALL NECESSARY PERMITS AND APPROVALS FROM THE LOCAL, STATE AND FEDERAL AGENCIES. THE CONTRACTOR SHALL BE RESPONSIBLE FOR OBTAINING ALL NECESSARY PERMITS AND APPROVALS FROM THE LOCAL, STATE AND FEDERAL AGENCIES. THE CONTRACTOR SHALL BE RESPONSIBLE FOR OBTAINING ALL NECESSARY PERMITS AND APPROVALS FROM THE LOCAL, STATE AND FEDERAL AGENCIES.

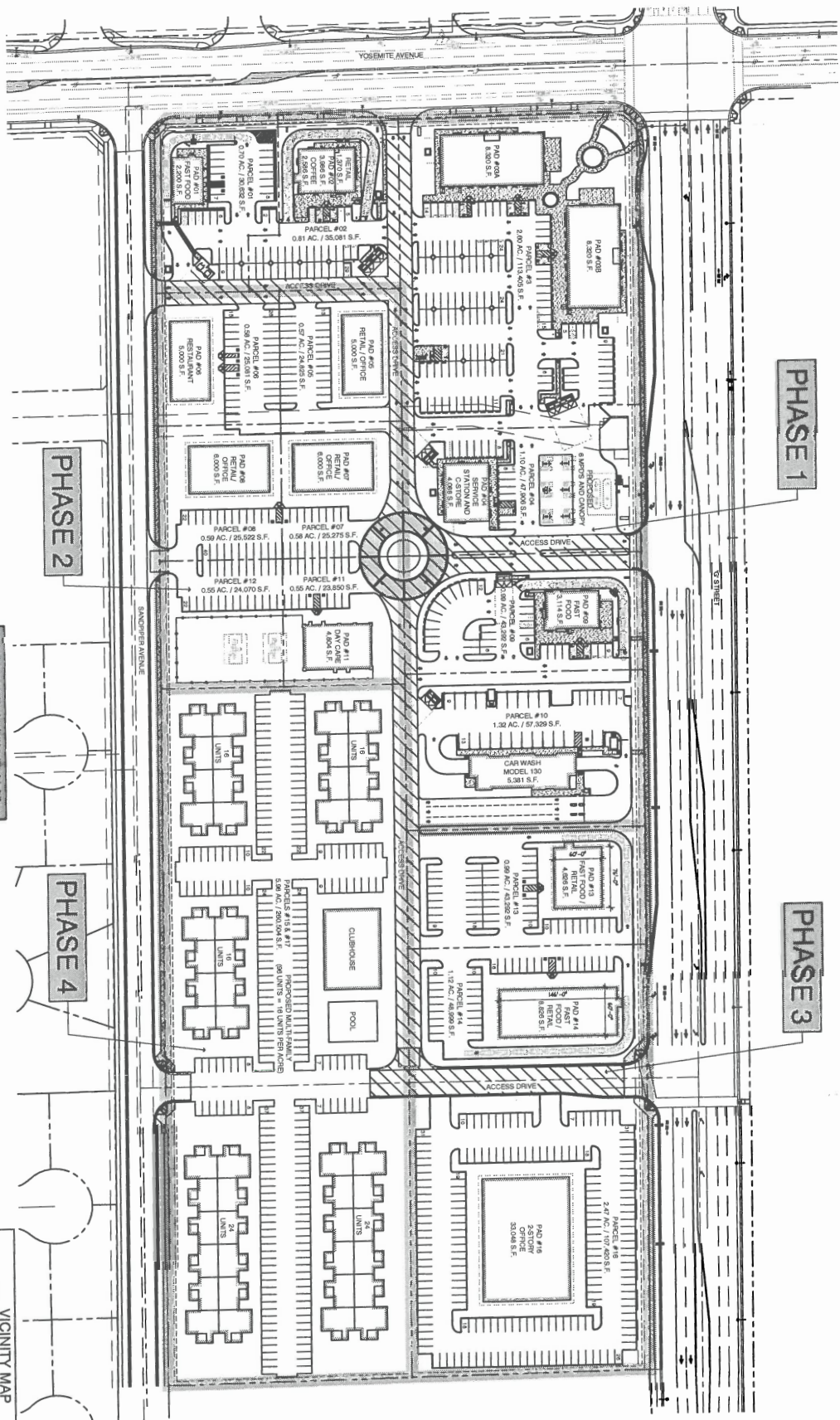

OVERALL PROPOSED SITE PLAN - SCHEME 3.0



PROJECT  
 PROPOSED COMMERCIAL DEVELOPMENT FOR:  
 YOSEMITE CROSSING  
 YOSEMITE AVENUE AND G STREET  
 MERCED, CALIFORNIA 95340

STATUS	DATE	DESCRIPTION
Current	06-23	Final Design
Revised	06-23	Final Design
Revised	06-23	Final Design
Revised	06-23	Final Design

REVISIONS	DATE	DESCRIPTION
1		
2		
3		
4		

SCENE	DATE	DESCRIPTION
1		
2		
3		
4		

SCALE: 1" = 30'

DATE: 06-23

PROJECT: YOSEMITE CROSSING

DESIGNER: CENTERLINE DESIGN, INC.

SCALE: 1" = 30'

DATE: 06-23

PROJECT: YOSEMITE CROSSING

DESIGNER: CENTERLINE DESIGN, INC.

SCALE: 1" = 30'

DATE: 06-23

PROJECT: YOSEMITE CROSSING

DESIGNER: CENTERLINE DESIGN, INC.

SCALE: 1" = 30'

DATE: 06-23

PROJECT: YOSEMITE CROSSING

DESIGNER: CENTERLINE DESIGN, INC.

SCALE: 1" = 30'

DATE: 06-23

PROJECT: YOSEMITE CROSSING

DESIGNER: CENTERLINE DESIGN, INC.



CENTERLINE DESIGN, INC.  
 1000 TULLY ROAD, SUITE 100  
 MERCED, CALIFORNIA 95340  
 (209) 385-1111  
 WWW.CENTERLINEDESIGN.COM