

# LOCATION MAP

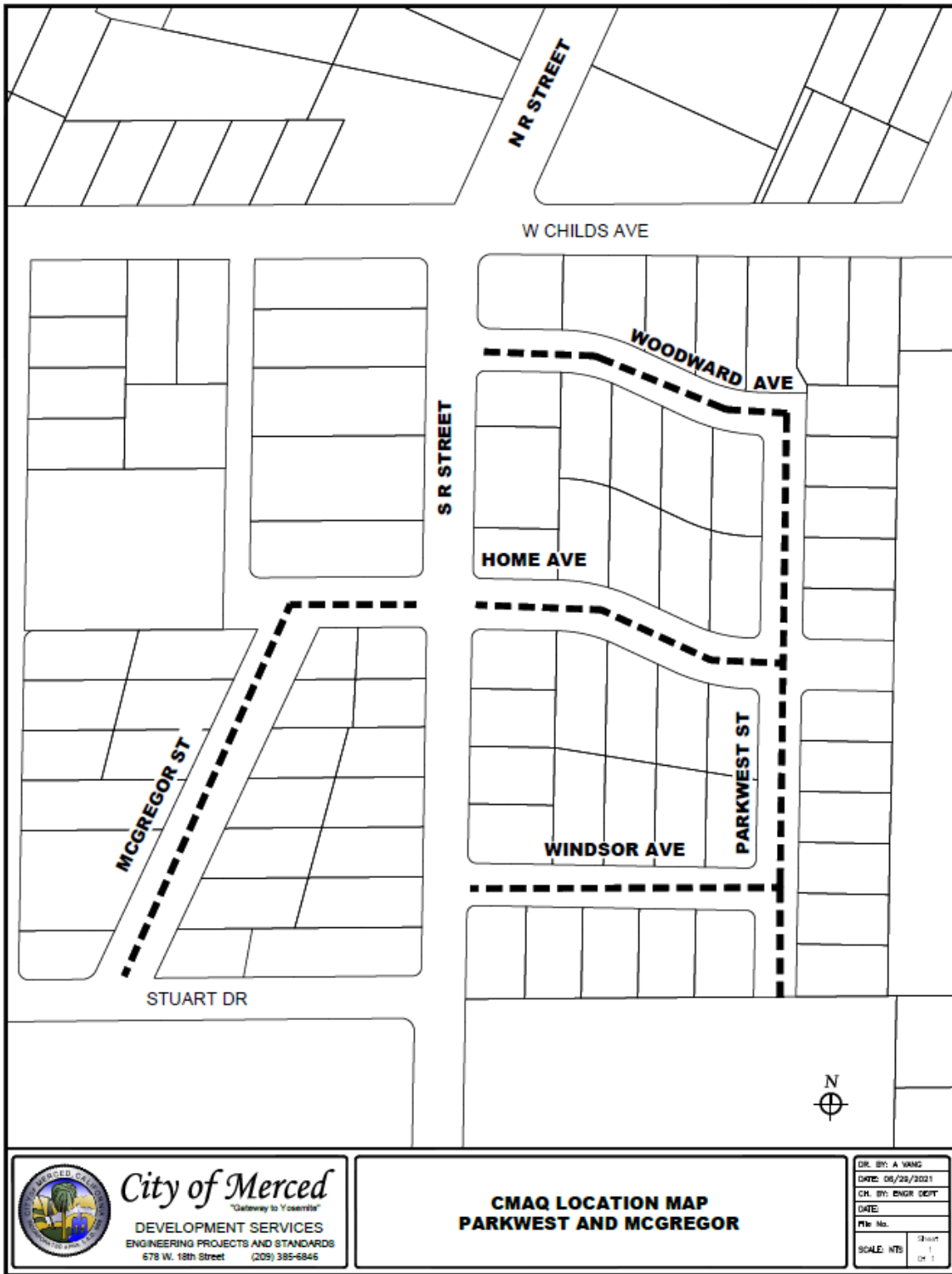

Plot Date: March 26, 2024  
I:\1 Current Projects\CP220064 - CMAQ (060) Parkwest, McGregor\1 - Design\Drawing\Loc Map.dwg



**City of Merced**  
"Gateway to Yosemite"  
DEVELOPMENT SERVICES  
ENGINEERING PROJECTS AND STANDARDS  
678 W. 18th Street (209) 385-6846

**CMAQ LOCATION MAP  
PARKWEST AND MCGREGOR**

DR. BY: A WANG	
DATE: 08/29/2021	
CH. BY: ENGR DEPT	
DATE:	
File No.	
SCALE: NTS	Sheet 1 of 1