

BARCLAY WAY

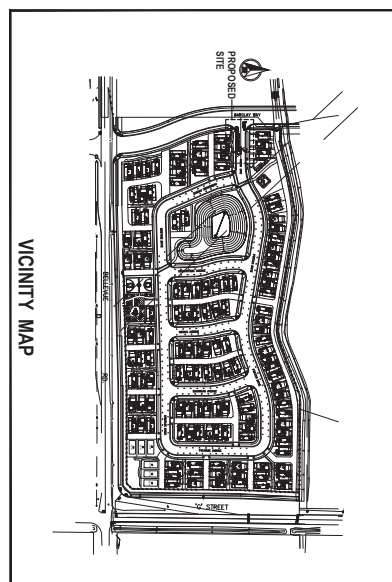
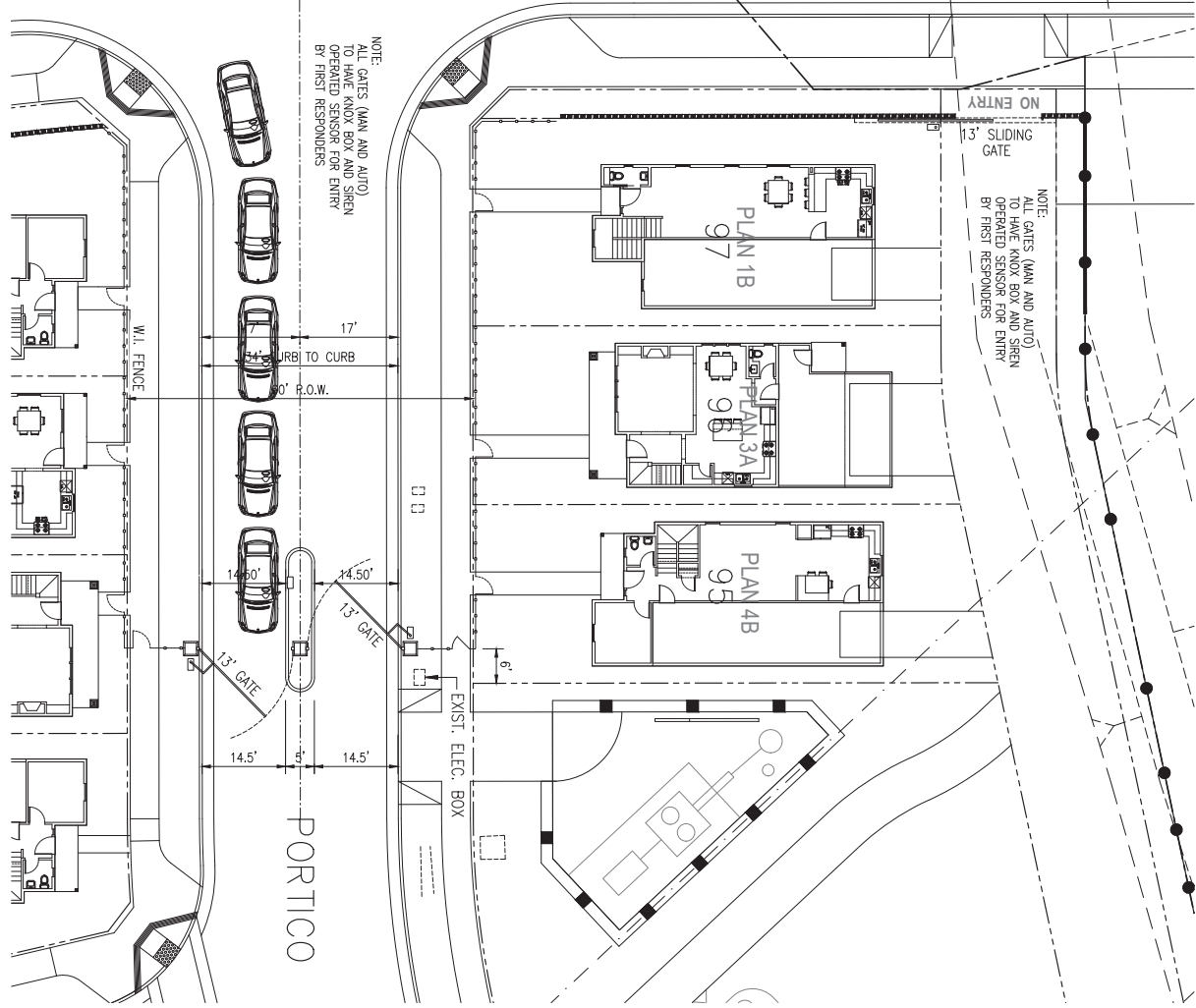
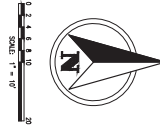

**SITE PLAN FOR PROPOSED SECURITY GATE
 PASEO SUBDIVISION**

JOB SITE:
 NORTHWEST CORNER OF BELLEVUE RD. & 'G' STREET
 CITY OF MENAFO, CA 95348

GOLDEN VALLEY
 ENGINEERING & SURVEYING

11000 BELLEVUE RD., SUITE 200
 MENAFO, CA 95348
 TEL: (925) 723-2554
 FAX: (925) 723-2554

DATE: 10/20/22
 DRAWN BY: [Name]
 CHECKED BY: [Name]
 PROJECT NO.: 21-167

1

MG STAR, LLC
 Attn: Mike Gahan
 P.O. Box 25643
 Menlo Park, CA 94025
 Tel: (650) 994-1187

Proposed Security Gate