

# City of Merced

RQ#:

## Citizen Action Request Form: Traffic Committee

Contact Person: Dr. Doug Williams Day Phone: [REDACTED]Email Address: [REDACTED]Address: [REDACTED] Today's Date: 2/9/24

Location of Concern (map attachments and photographs are encouraged):

Margaret Sheehy Elementary School, 1240 W 6th Street, Merced, CA 95341

Describe Concerns At This Location:

Merced City School District is currently conducting modernization of the elementary school campus. As a part of the increment #2 improvements the campus is scheduled to receive adjustments to the school bus drop off and pick up location located on the "T" Street side of the campus. The District is requesting that this area be designated as an enforceable school bus stop and "no parking zone". Please refer to the attachments provided.

### For Official Use Only:

Project #: \_\_\_\_\_ Date Received: \_\_\_\_\_ Date Field Inspected: \_\_\_\_\_

Field Inspection Results: \_\_\_\_\_

Date Response To Contact Person: \_\_\_\_\_

Resolution of Concern: \_\_\_\_\_

Date Completed: \_\_\_\_\_

\_\_\_\_\_  
Traffic Engineer's Signature or Designee\_\_\_\_\_  
Date

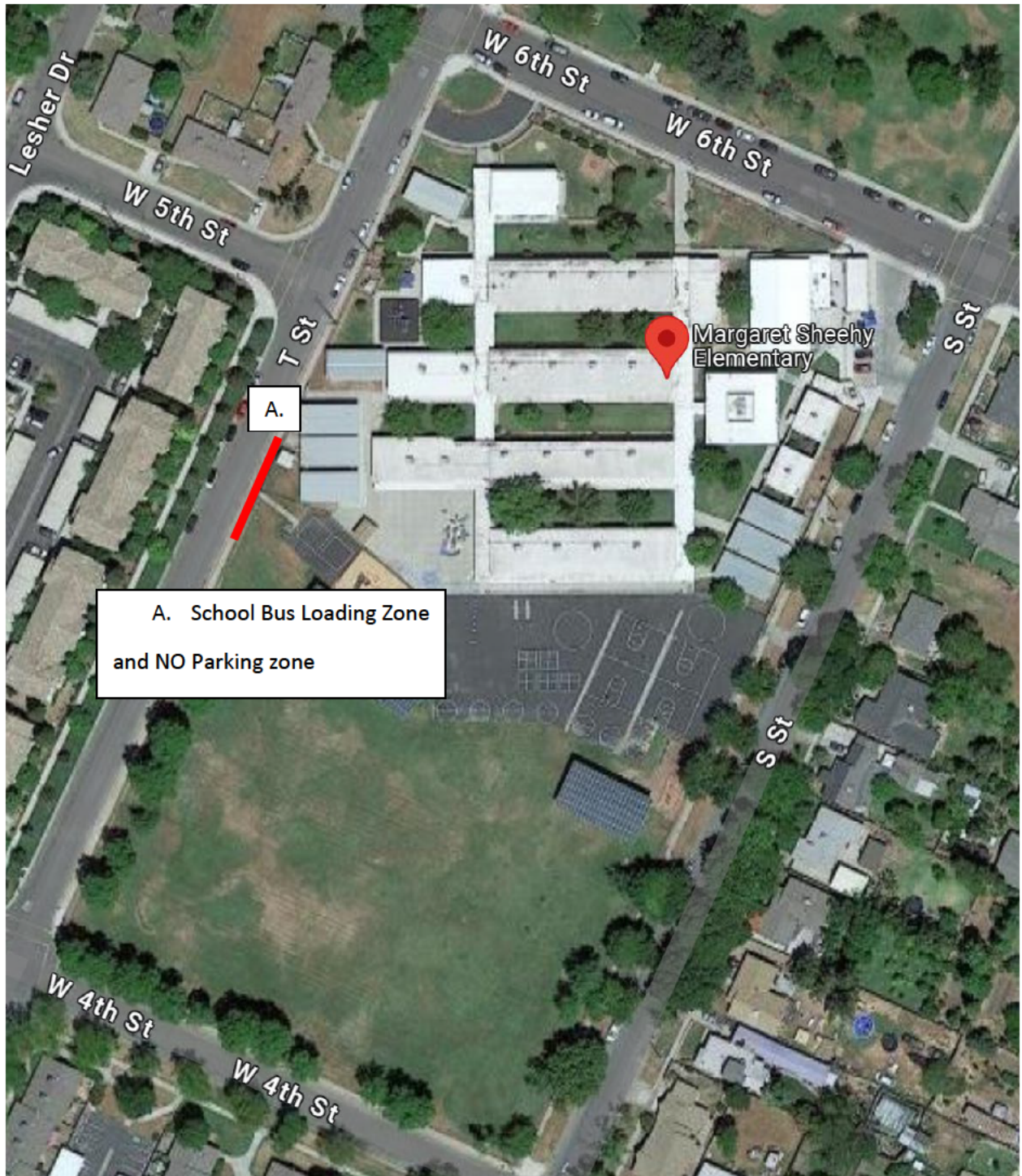

A.

Margaret Sheehy  
Elementary

A. School Bus Loading Zone  
and NO Parking zone



we can add a sign similar to the signs below,  
they are cheap aluminum reflected, meets the intent.











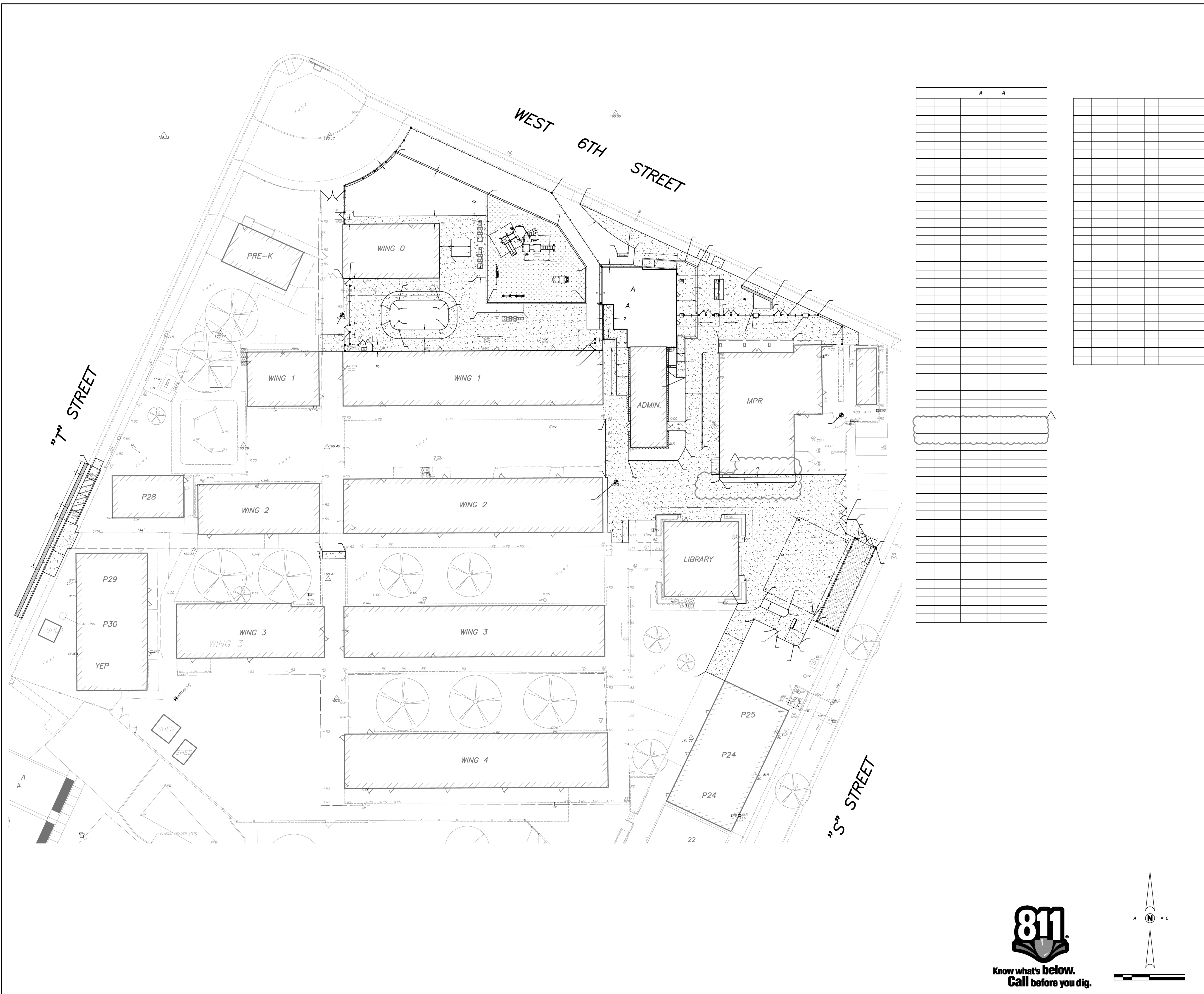

2 3

S

2 2 98

1000 AY A

100 SLP Y

200 BLP Y

1000 A

1000 A

1000 A

2 A AY A Y A A

W A O A 8 9 X O

W O Y W W A

3 W A O 2 8 O X 9

A WA A W 2 A

W A 2 2 8 X

A A A A X A Y 8

A A A W W

**Blair, Church & Flynn**  
CONSULTING ENGINEERS

Blair, Church & Flynn  
Consulting Engineers  
451 Clovis Avenue,  
Suite 200  
Clovis, California 93612  
Tel (559) 326-1400  
Fax (559) 326-1500

3/10/2023  
Date Signed

Margaret Sheehy Elementary School  
Modernization Increment 2

d A y h

Z A A

**ARCHITECTURE  
PLANNING  
INTERIORS**  
architects  
www.dardenarchitects.com  
6790 N. West Ave. • Fresno, CA 93711 • T. 559.448.8051

3/10/2023  
Date Signed

A A

B

O

S = 0 B

B

SD C401

S

811

Know what's below.  
Call before you dig.

A N = 0

AD3-CX02



