

**COMMUNITY FACILITIES DISTRICT NO. 2003-2 (SERVICES)
OF THE CITY OF MERCED
ANNEXATION NO. 25
(IMPROVEMENT AREA NO. 50)**

STATE OF CALIFORNIA,
SHEET 1 OF 1

CITY OF MERCED, COUNTY OF MERCED
FEBRUARY 12, 2024

SCALE: 1"=150'

RECORDER'S STATEMENT

FILED THIS _____ DAY OF _____ AT THE HOUR OF _____ O'CLOCK _____ M.,
IN BOOK _____ OF MAPS OF ASSESSMENT AND COMMUNITY FACILITIES DISTRICT AT PAGES _____ IN THE
OFFICE OF THE COUNTY RECORDER IN THE COUNTY OF MERCED, STATE OF CALIFORNIA.

MATT H. INAY
MERCED COUNTY RECORDER

DOCUMENT NO. _____
FEE _____

BY: _____
MERCED COUNTY DEPUTY RECORDER

REFERENCES

1. PARCEL MAP FOR EXPOSITION PROPERTIES, LLC AND LEECO, LLC
RECORDED IN BOOK 118, OF PARCEL MAPS, PAGES 3-7, M.C.R.

LEGEND

- O.P. OFFICIAL PLATS
- P.M. PARCEL MAPS
- M.C.R. Merced County Records.

CITY ENGINEER

MICHAEL A. WEGLEY, R.C.E. 45009
INTERIM CITY ENGINEER
CITY OF MERCED

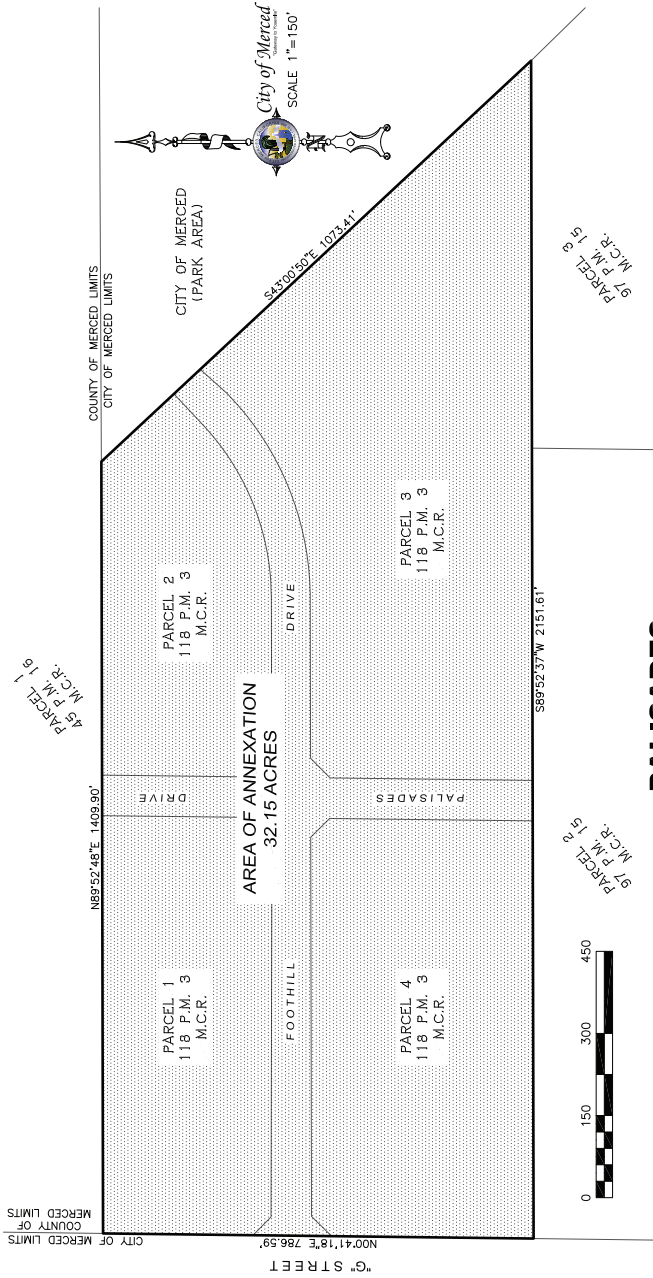

AREA OF ANNEXATION

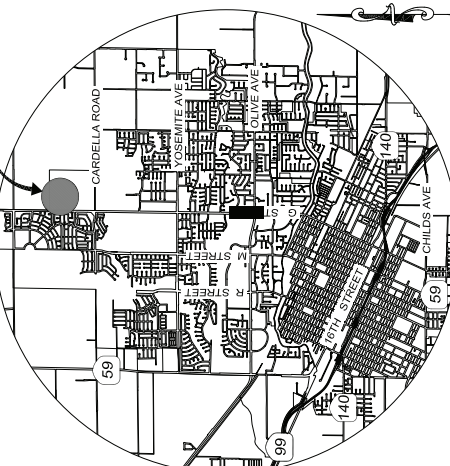

VICINITY MAP

NOT TO SCALE

PALISADES

CITY CLERK STATEMENT

FILED IN THE OFFICE OF THE CITY CLERK OF THE CITY OF MERCED THIS _____ DAY OF _____, 2024.

SCOTT McBRIDE
CITY CLERK
CITY OF MERCED

I HEREBY CERTIFY THAT THE WITHIN MAP SHOWING PROPOSED BOUNDARIES OF CITY OF MERCED COMMUNITY FACILITIES DISTRICT NO. 2003-2 (SERVICES) OF THE CITY OF MERCED, ANNEXATION 25 (IMPROVEMENT AREA 50), IN THE CITY OF MERCED AND THE COUNTY OF MERCED, STATE OF CALIFORNIA, WAS APPROVED BY THE CITY COUNCIL BY ITS RESOLUTION NO. _____ OF _____, 2024.

SCOTT McBRIDE
CITY CLERK
CITY OF MERCED

CITY SURVEYOR'S STATEMENT

THIS MAP WAS PREPARED BY ME OR UNDER MY DIRECTION IN CONFORMANCE WITH THE LAND SURVEYOR'S ACT ON _____, 2024.

JOE M. CARDOSO, P.L.S. #8851