

This drawing is not a construction document. It is to be used for spaceplanning, reference, and installing furniture. This drawing is property of Core Business Interiors and is subject to return upon request. This drawing cannot be made public or reproduced unless authorized by Core Business Interiors.

scale: N.T.S.

drawn by: date:
MD 01.18.22

revised by: date:
: 01.19.22

: :
: :
: :

Sheet:

2

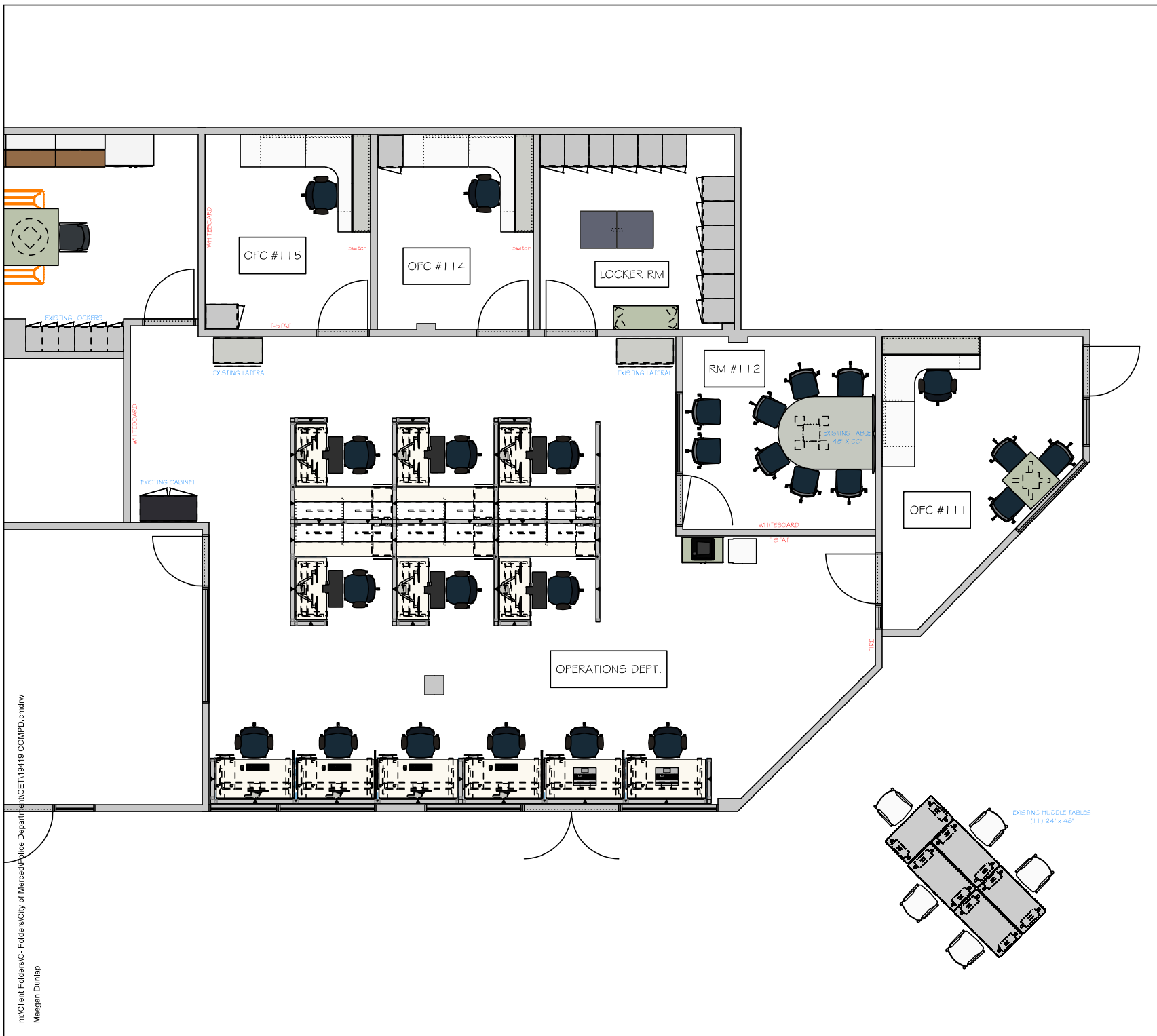

m:\Client Folders\C- Folders\City of Merced\Police Department\CET119419 COMFD.dcmdrw
Maegan Dunlap

This drawing is not a construction document. It is to be used for spaceplanning, reference, and installing furniture. This drawing is property of Core Business Interiors and is subject to return upon request. This drawing cannot be made public or reproduced unless authorized by Core Business Interiors.

scale: N.T.S.

drawn by: MD
date: 01.18.22

revised by: :
date: 01.19.22

: :
: :
: :
: :

Sheet:

3



INVESTIGATIONS
(15) 7'-0" x 7'-6" stations

- 74"H panels
- 42"W sliding door (frosted glass)
- Glass stack panels
- Exterior laminate tiles
- Whiteboard tile
- 30 x 60 height adjustable desk
- 18"W x 24"D x 66"H locker
- Mobile BF pedestal w/ cushion top
- 48"W open shelf w/ task light
- 48"W tack board
- Dual-monitor arm

Client Signature

City of Merced Police Department

1735 M Street

Merced, CA 95340

RPC#: 19419

This drawing is not a construction document. It is to be used for spaceplanning, reference, and installing furniture. This drawing is property of Core Business Interiors and is subject to return upon request. This drawing cannot be made public or reproduced unless authorized by Core Business Interiors.

scale: N.T.S.

drawn by: MD
date: 01.18.22

revised by: :
date: 01.19.22

: :
: :
: :
: :

Sheet:

4



OPERATIONS

(6) 6'-0" x 6'-0" stations

66"H panels

Glass stack wing panels

Exterior laminate tiles

Whiteboard tile

24 x 48 height adjustable desk

BBF storage pedestal

(2) 36"W shelves w/ task lights

36"W tack board

Dual-monitor arm

Keyboard tray

Client Signature

City of Merced Police Department

1735 M Street

Merced, CA 95340

RPC#: 19419



OPERATIONS - BENCHING

- 50"H panels
- Fabric tiles
- 30 x 60 height adjustable desks
- Mobile BF pedestal w/ cushion top
- Fabric territory screens
- (4) single-monitor arms

This drawing is not a construction document. It is to be used for spaceplanning, reference, and installing furniture. This drawing is property of Core Business Interiors and is subject to return upon request. This drawing cannot be made public or reproduced unless authorized by Core Business Interiors.

scale:	N.T.S.
drawn by:	date:
MD	01.18.22
revised by:	date:
:	01.19.22
:	:
:	:
:	:
:	:

Sheet:

5

Client Signature



Task

Conference

Stacking

Conference

Task

INVESTIGATIONS

OPERATIONS

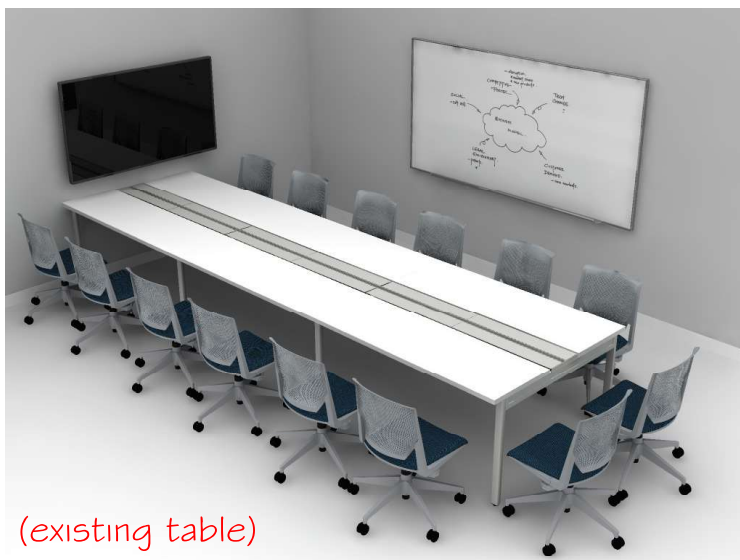

(existing table)

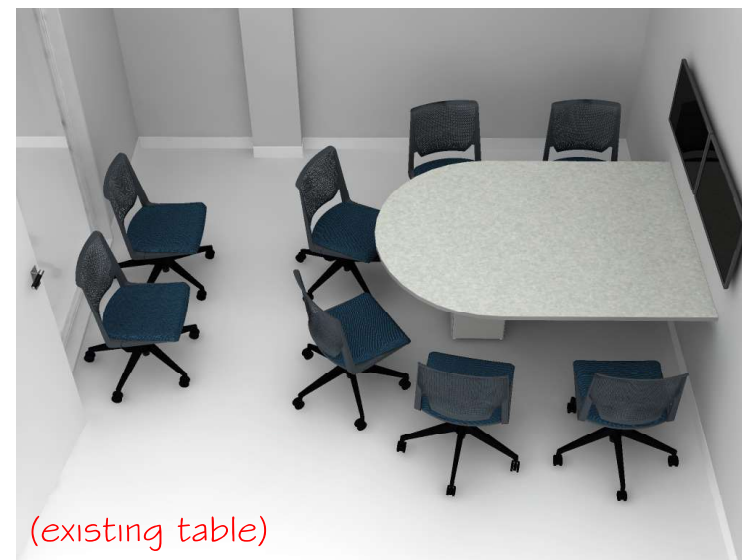

(existing table)

City of Merced Police Department

1735 M Street

Merced, CA 95340

RPC#: 19419

This drawing is not a construction document. It is to be used for spaceplanning, reference, and installing furniture. This drawing is property of Core Business Interiors and is subject to return upon request. This drawing cannot be made public or reproduced unless authorized by Core Business Interiors.

scale: N.T.S.

drawn by: MD
date: 01.18.22

revised by: :
date: 01.19.22

: :
: :
: :
: :

Sheet:

6

Client Signature