



Williams Scotsman inc
2829 S Chestnut Avenue
FRESNO CA 93725
Toll Free: 800-782-1500

Your Sales Representative
Ben Hostetler
Phone: (559) 653-8054
Email:
benjamin.hostetler@willscot.com

Agreement Number:
Q-1389674
Revision: 2
Date: 5/18/2023
Expiration Date:
6/16/2023

Lease Agreement

Lessee:0010537791
CITY OF MERCED
678 W 18th ST
Merced, CA 95340

Contact:
Joe Cardoso
678 West 18th Street
Merced, CA 95340, US
Phone: 2093887508
Email: cardosoj@cityofmerced.org

Ship To Address:
Stephen Leonard Park
Merced, CA 95341, US
Estimated Delivery Date :5/24/2023

Rental Pricing Per Billing Cycle	Quantity	Price	Extended
64x24 Modular (60x24 Box)	1	\$ 2,417.00	\$ 2,417.00
Loss Damage Waiver (11/12)	2	\$ 159.00	\$ 318.00
PERSONAL PROPERTY EXPENSE	1	\$ 101.51	\$ 101.51
General Liability Insurance	1	\$ 26.40	\$ 26.40
Restroom - Standard	2	\$ 200.00	\$ 400.00
ADA/IBC Switchback Ramp - 36ft & Larger	1	\$ 620.00	\$ 620.00
Premium 4-Office/1-Conf. Package	1	\$ 900.00	\$ 900.00
Window/Door Security Bundle - 40ft & Greater	1	\$ 90.00	\$ 90.00
Data Hub - Rental	2	\$ 141.12	\$ 282.24
Prof. Entrance - Steps w/ Canopy	1	\$ 153.12	\$ 153.12

Minimum Lease Billing Period: 10

Total Recurring Building Charges:	\$ 2,417.00
Subtotal of Other Recurring Charges:	\$ 2,891.27
Total Recurring Charges Per Billing Cycle:	\$ 5,308.27
Total Recurring Charges Per Billing Cycle Including Estimated Taxes:	\$ 5,746.21

Estimated Delivery And Installation

Ramp - Knockdown & Return	1	\$ 1,300.00	\$ 1,300.00
Return - 12' wide	2	\$ 1,203.00	\$ 2,406.00
Essentials Material Handling	1	\$ 1,677.18	\$ 1,677.18
Standard Complex Setup and Anchor	1	\$ 4,182.00	\$ 4,182.00
Standard Complex Skirting Removal	1	\$ 818.00	\$ 818.00
Standard Complex Wood Skirting	1	\$ 3,270.00	\$ 3,270.00
Standard Complex Knockdown	1	\$ 2,509.00	\$ 2,509.00
CA Transport Delivery Fee	1	\$ 200.00	\$ 200.00
Hitch removal	1	\$ 1.00	\$ 1.00
Fuel Surcharge Delivery	2	\$ 324.81	\$ 649.62
Fuel Surcharge Return	2	\$ 324.81	\$ 649.62
Ramp - Delivery & Installation	1	\$ 1,300.00	\$ 1,300.00
Delivery - 12' wide	2	\$ 1,203.00	\$ 2,406.00
Total Delivery and Installation Charges:			\$ 21,368.42
Total Delivery and Installation Charges Including Estimated Taxes:			\$ 23,131.32

Estimated Final Return Charges*

CA Transport Return Fee	1	\$ 200.00	\$ 200.00
-------------------------	---	-----------	-----------



Williams Scotsman inc
2829 S Chestnut Avenue
FRESNO CA 93725
Toll Free: 800-782-1500

Your Sales Representative
Ben Hostetler
Phone: (559) 653-8054
Email:
benjamin.hostetler@willscot.com

Agreement Number:
Q-1389674
Revision: 2
Date: 5/18/2023
Expiration Date:
6/16/2023

Estimated Final Return Charges*

Hitch installation	1	\$ 1.00	\$ 1.00
Due On Final Invoice*:			\$ 201.00
Due On Final Invoice Including Estimated Taxes*:			\$ 217.58
Total Including Recurring Billing Charges, Delivery, Installation and Return**:			\$ 74,652.12
Total Including Recurring Billing Charges, Delivery, Installation and Return Including Estimated Taxes**:			\$ 80,811.00

Scope Of Work

Summary of Charges

Model: 64x24 Modular (60x24 Box)	Quantity: 1	Total Charges for (1) Building(s): \$ 74,652.12
		Total Charges for (1) Building(s) Including Estimated Tax: \$ 80,811.00

Additional Services: For your convenience, we also recommend the following items (not included in this Agreement)

BY INITIALING BELOW, BUYER/LESSEE/CUSTOMER HEREBY ACKNOWLEDGES AND CONFIRMS THAT IT HAS SELECTED THE INITIALED RECOMMENDED ITEMS TO BE ADDED TO THIS CONTRACT AND AGREES TO PAY THE ADDITIONAL SPECIFIED AMOUNT(S) IN ACCORDANCE WITH THE TERMS AND CONDITIONS OF THIS CONTRACT.

Initial	Recommended Items	Billing Frequency	Qty	Price	Extended
---------	-------------------	-------------------	-----	-------	----------



Williams Scotsman inc
2829 S Chestnut Avenue
FRESNO CA 93725
Toll Free: 800-782-1500

Your Sales Representative
Ben Hostetler
Phone: (559) 653-8054
Email:
benjamin.hostetler@willscot.com

Agreement Number:
Q-1389674
Revision: 2
Date: 5/18/2023
Expiration Date:
6/16/2023

Insurance Requirements Addendum

QTY	PRODUCT	EQUIPMENT VALUE/BUILDING	DEDUCTIBLE PER UNIT
1	64x24 Modular (60x24 Box)		\$0.00

Lessee: CITY OF MERCED

Pursuant to the Williams Scotsman Lease Agreement and its Terms and Conditions ("Agreement"), a Lessee is obligated to provide insurance to Williams Scotsman, Inc. ("Lessor") with the following insurance coverage:

- 1. Commercial General Liability Insurance:** policy of combined bodily injury and property damage insurance insuring Lessee and Lessor against any liability arising out of the use, maintenance, or possession of the Equipment. Such insurance shall be in an amount not less than \$1,000,000 per occurrence, naming the Lessor as Additional Insured and Loss Payee.
- 2. Commercial Property Insurance:** covering all losses or damage, in an amount equal to 100% of the Equipment Value set forth in the Lease providing protection against perils included within the classification and special extended perils (all "risk" insurance), naming the Lessor as Additional Insured and Loss Payee.

By signing below, the Lessee agrees to the terms and conditions stated herein. All other general Terms and Conditions of the Agreement shall remain the same and in full force and effect. Each party is hereby authorized to accept and rely upon a facsimile or electronic signature of the other party on this Addendum. Any such signature shall be treated as an original signature for all purposes.

General Liability Insurance Program

Lessee elects to participate in the General Liability Insurance Program, whereby Lessee will receive insurance coverage through American Southern Insurance Company ("Insurer") and administered by Allen Insurance Group ("Agent"). The Lessee acknowledges and agrees that the policy issued by the Insurer is a third party liability policy that covers those amounts that Lessee is legally obligated to pay due to bodily injury and property damage arising from the proper use and occupancy of Equipment leased from Williams Scotsman up to the policy limits. Coverage is subject to underwriting and specific terms and conditions set forth in the policy. An outline of cover is available upon request. By signing below, Lessee understands and agrees that the Lessor is not providing the insurance coverage and serves only as a billing agent for the Insurer and its Agent; and, accordingly, it assumes no liability therefore.

Signature of Lessee: _____ Print Name: _____ Date: _____

Damage Waiver Program

Lessee elects to participate in the Lessor's Damage Waiver Program. Lessee understands and agrees that under this program, the Lessor waives, for a fee, Lessee's obligation to carry Commercial Property Insurance and Lessee's liability to Lessor for repair or replacement of the modular units leased from Williams Scotsman resulting from loss or damage as specified in the Lease Agreement. Lessee remains liable to Williams Scotsman for the amount of the damage deductible per unit of equipment noted above. Please refer to the Agreement for specific details on coverage, exclusions and restrictions on coverage. The Property Damage Waiver is not and shall not constitute a contract for insurance.

Signature of Lessee: _____ Print Name: _____ Date: _____

Please return this signed document with the signed lease agreement.



Williams Scotsman inc
2829 S Chestnut Avenue
FRESNO CA 93725
Toll Free: 800-782-1500

Your Sales Representative

Ben Hostetler
Phone: (559) 653-8054

Email:
benjamin.hostetler@willscot.com

Agreement Number:

Q-1389674

Revision: 2

Date: 5/18/2023

Expiration Date:
6/16/2023

Clarifications

***Final Return Charges are estimated and will be charged at Lessor's prevailing rate at time of return. **All prices include estimated taxes if applicable. All Lessees and Leases are subject to credit review.** In addition to the stated prices, customer shall pay any local, state or provincial, federal and/or personal property tax or fees related to the equipment identified above ("Equipment"), its value or its use. Lessee acknowledges that upon delivery of the Equipment, this Agreement may be updated with the actual serial number(s), delivery date(s), lock serial number(s), etc, if necessary and Lessee will be supplied a copy of the updated information. Prices exclude taxes, licenses, permit fees, utility connection charges, site preparation and permitting which is the sole responsibility of Lessee, unless otherwise expressly agreed by Lessor in writing. Lessee is responsible for locating and marking underground utilities prior to delivery and compliance with all applicable code requirements unless otherwise expressly agreed by the Lessor in writing. Price assumes a level site with clear access. Lessee must notify Lessor prior to delivery or return of any potentially hazardous conditions or other site conditions that may otherwise affect delivery, installation, dismantling or return of any Equipment. Failure to notify Lessor of such conditions will result in additional charges, as applicable. Physical Damage & Commercial Liability insurance coverage is required beginning on the date of delivery. Lessor is not responsible for changes required by code or building inspectors. **Pricing is valid for thirty (30) days.**

Please note the following important billing terms:

- In addition to the first billing period rental and initial charges, last billing period rent for building and other recurring rentals/services (excluding General Liability Insurance and Property Damage Waivers), will be billed on the initial invoice. Any amounts prepaid to Williams Scotsman will be credited on the final invoice.
- Invoices are due on receipt, with a twenty (20) day grace period. Interest will be applied to all past due amounts.
- Invoices are due on receipt, with a twenty (20) day grace period. Late fees will be applied to all past due amounts.
- Williams Scotsman preferred method of payment is ACH. Payments made by check are subject to a Paper Check Fee, charged on the next invoice following payment by check. ***LESSEE EXEMPT**
- Williams Scotsman preferred method of invoicing is via electronic transmission. Customers are encouraged to provide an email address or use MMConnect. Invoices sent standard mail are subject to a paper invoice fee, charged on the following invoice. ***LESSEE EXEMPT**

Lessor hereby agrees to lease to Lessee and Lessee hereby agrees to lease from Lessor Modular Equipment and Value Added Products (as such items are defined in Lessor's General Terms & Conditions) selected by Lessee as set forth in this Agreement. All such items leased by the Lessee for purposes of this Lease shall be referred to collectively as the "Equipment". By its signature below, Lessee hereby acknowledges that it has read and agrees to be bound by the Lessor's General Terms & Conditions (6-3-22) located on Lessor's internet site (<https://www.willscot.com/About/terms-conditions>) in their entirety, which are incorporated herein by reference and agrees to lease the Equipment from Lessor subject to the terms therein. Although Lessor will provide Lessee with a copy of the General Terms & Conditions upon written request, Lessee should print copies of this Agreement and General Terms & Conditions for recordkeeping purposes. Each party is authorized to accept and rely upon a facsimile signature, digital, or electronic signatures of the other party on this Agreement. Any such signature will be treated as an original signature for all purposes and shall be fully binding. The undersigned represent that they have the express authority of the respective party they represent to enter into and execute this Agreement and bind the respective party thereby.

Invoicing Options (select one)

[] Paperless Invoicing Option

Williams Scotsman prefers electronic invoicing, an efficient, convenient and environmentally friendly process. To avoid fees, provide us with the proper email address for your invoices.

Corrected Email Address: _____

[] Standard Mail Option

Customer prefers to receive paper invoice via mail. Fees may apply. Invoices will be mailed to:

678 W 18th ST
Merced, CA, 95340, US

Enter a new billing address: _____



Williams Scotsman inc
2829 S Chestnut Avenue
FRESNO CA 93725
Toll Free: 800-782-1500

Your Sales Representative
Ben Hostetler
Phone: (559) 653-8054
Email:
benjamin.hostetler@willscot.com

Agreement Number:
Q-1389674
Revision: 2
Date: 5/18/2023
Expiration Date:
6/16/2023

Signatures**Lessee: CITY OF MERCED****Lessor: Williams Scotsman inc**

Signature:

Signature:

Print Name:

Print Name:

Title:

Title:

Date:

Date:

PO#:

64' x 24' SECTION MODULAR



In addition to your office solution, we can provide additional products and services that complete your space- creating a more productive, comfortable, and safe work environment.

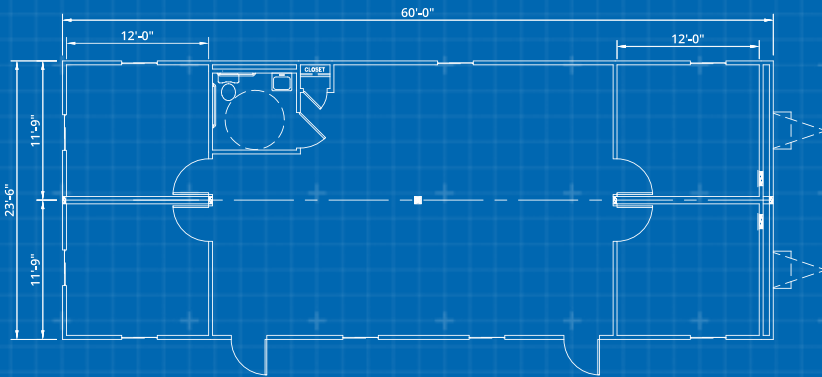

CUSTOMIZATION

- Steps & Ramps
- Furniture & Appliances
- Technology
- Site Services
- Loss Protection

Dimensions

- 64' Long (including hitch)
- 60' Box size
- 24' Wide
- 8' Ceiling height
- Other double-wide sizes are available

Exterior Finish

- Aluminum or wood siding
- I-Beam Frame
- Standard drip rail gutters

Interior Finish

- Paneled walls
- Carpet or vinyl tile floor
- Gypsum Ceiling
- Private office(s)

Electric

- Fluorescent ceiling lights
- Single phase electric and breaker panel

Heating/Cooling

- Central HVAC

Windows/Doors

- Horizontal slider windows
- (2) Vision panel doors with standard locks or (2) steel doors with dead bolt lock

Other

- Optional restroom